

OFFICE OF THE PRINCIPAL, SWARNACHUD COLLEGE, MITRAPUR, BALASORE

www.swarnachudcollege.com, e- mail: - swarnachud@rediffmail.com

NAAC ACCREDITED WITH 'B' GRADE

Notice No-02/2022-23/OHEPEE

Date.....05/01/2023

Tender Notice

Sealed quotations are invited from reputed firms/suppliers/dealers with valid GST registration, PAN, IT return & Authorisation Certificate from the manufacturer for supply of various items of Swarnachud College, Mitrapur, Balasore under World Bank Assisted Project, OHEPEE, Govt. Of Odisha so as to reach the undersigned on or before **21.01.2023, 5 PM** by Speed Post/Registered Post/ Courier Service. The authority reserves the right to accept or reject any or all quotations without assigning any reason thereof.

For details, please log on to www.swarnachudcollege.com

Ganapati
Principal
Swarnachud College
Mitrapur
5-1-2023

Memo No:-03/2022-23/OHEPEE

Date:- 05/01/2023

Copy forwarded to Accounts Bursar/ College Notice Board for information.

Ganapati
Principal
Swarnachud College
Mitrapur
5-1-2023



Swarnachud College, Mitrapur, Balasore

Tender Documents

For

Supply of laboratory Island tables (EPOXY Based), wall side tables (EPOXY Based), chemicals storage cabinet (EPOXY Based), white/green boards (Ceramic / non-ceramic) for Physics (A), Chemistry (B), Botany (C), Zoology (D) Departments and Class Rooms.

At

Swarnachud College, Mitrapur, Balasore.

Tender Document No: 02/2022-23/OHEPEE

Dated: 07.01.2023

Issued by:

Principal,

Swarnachud College,

Mitrapur, 756020

Swarnachud
Principal,
Swarnachud College
Mitrapur
5.1.2023

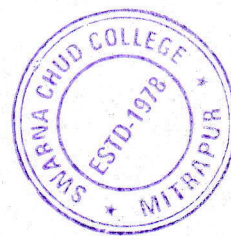

TABLE OF CONTENTS

DESCRIPTION	PAGE NO.
Schedule for tender	03
Eligibility criteria	04
Bid submission	05
General terms and conditions of the bid	06
Annexure I- Items to be supplied and installed	09
Annexure II – Details of the tender	23
Annexure III- Price schedule	24
Annexure-IV Self-declaration for not blacklisted	25

Samalendu
Principal,
Swarnachud College
Mitrapur
5-1-2023



SCHEDULE OF TENDER

Tender No.	02/2022-23/OHEPEE
Name of the tender issuer	Principal, Swarnachud College, Mitrapur
Scope of work	Supply of laboratory Island tables (EPOXY Based), wall side tables (EPOXY Based), chemicals storage cabinet (EPOXY Based), white/green boards (Ceramic / non-ceramic) for Physics (A), Chemistry (B), Botany (C), Zoology (D) Departments and class rooms
Cost/fees of tender Documents	Rs. 500/--in the form of DD drawn in favour of Principal, Swarnachud College, Mitrapur payable at IOB, Chaturikhunta Branch, Mitrapur at the time of submission of tender documents.
Earnest Money Deposit (EMD)/ BID security	5% of bid value in form of DD drawn in favour of Principal, Swarnachud College, Mitrapur payable at IOB, Chaturikhunta Branch, Mitrapur at the time of submission of tender document.
Performance Bank Guarantee (PBG)	5% of bid value in form of DD drawn in favour of Principal, Swarnachud College, Mitrapur payable at IOB, Chaturikhunta Branch, Mitrapur at the time of issue of purchase order.
Date of issue of tender document	07.01.2023
Date and time of pre bid clarification	12.01.2023
Last date and time for submission of bids	21.01.2023
Date and time of opening of technical bids	24.01.2023
Date and time of price bids opening	24.01.2023
Name of the contact person for communication	Mr. Prasanna Kumar Mohapatra-9778257722, S.P. Chand (HOD Chemistry)-9437128979, Dr. S.K. Panda (HOD Physics)-9437266646, Mr. A. K. Sahu- (Lect. in Botany)-9861833325, Miss T. Mahapatra (HOD Zoology)- 9040372197
Address for communication	Principal, Swarnachud College, Mitrapur, 756020

Prasanna Kumar Mohapatra
5.1.2023
Principal,
Swarnachud College
Mitrapur



ELIGIBILITY CRITERIA

The bidders who are desirous for above work required fulfilling the following conditions:

1. Must be registered under GST Act.
2. Must have average annual turnover for the last three years i.e. 2019-2020, 20-21, and 21-22 should not be less than Rs2 lakhs. The bidders must have audited financial statement of preceding 3 financial years.
3. Must have authorization certificate from the manufacturer.
4. Must have ISO certificate for manufacturer.
5. Must have BIFMA Certificate for manufacturer.
6. Must have SEFA Certificate for manufacturer.
7. Must have Brit Quails certificate for manufacturer.
8. Must have income tax return of preceding 3 financial years.
9. Must have a valid PAN.
10. Should not have been blacklisted by any state Govt. / Central Govt. / PSU in India. A self-declaration is required as per **Annexure IV**.

Samalendu
5-1-2023
Principal,
Swarnachud College
Mitrapur



BID SUBMISSION

Steps to be followed for submission of bid:

The bid shall be submitted in three year parts, the **EMD**, Technical Bid and the price bid

- i) **Earnest Money Deposit (EMD):** Bidder has to submit **EMD** of required amount in the form of Demand draft drawn in favour of **Principal, Swarnachud College** payable at **IOB, Chaturikhunta Branch, Mitrapur**. The EMD should be sealed in one envelope marked as “**EMD**”.

Earnest money deposit will not carry any interest. The EMD of unsuccessful bidders will be refunded on acceptance of the work order by the successful bidder. The EMD of successful bidder will be returned on submission of performance security.

The bid not accompanying EMD is liable to be rejected.

- ii) The **technical bid** sealed in another envelope marked as “**Technical Bid**” and shall contains

- The bidder should supply the items as per technical specification mentioned in **Annexure I**. The list of items available with the concerned Department.
- The bidder should details as per **Annexure II**, duly filled in, signed and complete in all respects. No alteration / modification in the format shall be permitted.
- A self-declaration that the tenderer has not been blacklisted by any state Government/ PSU in India as per **Annexure IV**.
- Audited balance sheet and profit and loss account along with copy of acknowledgement of income Tax return of last three financial years i.e., 2019-20, 20-21, 21-22.

- iii) The **price bid** shall be sealed in an envelope marked as **price bid** and shall contain the price bid as per **Annexure III** duly completed in all respects.

Rate quoted should be inclusive of GST. No extra cost will be borne by the college towards transport of goods. No price increase on account of change in tax structure, duties, levies, charges etc. shall be permitted.

This **three** separate envelope containing EMD, technical bid and price bid should be sealed in one envelope and should be addressed as per tender schedule superscribed as “**Supply of laboratory Island tables (EPOXY Based), wall side tables (EPOXY Based), chemicals storage cabinet (EPOXY Based), white/green boards (Ceramic / non-ceramic) for Physics (A), Chemistry (B), Botany (C), Zoology (D) Departments and Class Rooms**”.

Swarnachud
Principal,
Swarnachud College
Mitrapur
5
2021-22

Principal,
Swarnachud College
Mitrapur



GENERAL TERMS AND CONDITION OF THE BID

NOTE: bidders must read these conditions carefully and comply strictly while submitting their bids.

1. Bidders shall prepare the bid and submit it in a sealed envelope addressed to **Principal, Swarnachud College, Mitrapur, Balasore** and send it through **speed post/ registered post/ Courier only** (No hand delivery will be entertained). Each envelope should bear the name of bidder, along with the Tender number. However the authorities shall not be responsible for postal and other delays in receipt of the bids.
2. Bidders are requested to check for any notice / amendment/ clarification etc. to the tender Documents through the website www.swarnachudcollege.com /Notice board of the office of the Principal Swarnachud College, Mitrapur and in the **Print Media**.
3. The bidders should note that prices should not be indicated in the Technical bid and should be quoted only in the price bid as per **Annexure III**. In case the prices are indicated in the technical bid, the bid shall stand rejected.
4. **“Pre bid meeting”** with the intending bidders shall be held on **12.01.2023**, 1 PM at Swarnachud college. Any queries related to this tender shall be sent to the mail ID: **swarnachud@rediffmail.com** one day in advance. The clarifications if any will be uploaded in the college website. All bidders are invited to attend the pre bid meeting. No deviation to any of the term will be permitted after freezing of the same at pre-bid meeting.
On the date of pre bid meeting, the bidders any make a site verification where installations is to be made.
5. **OPENING OF TECHNICAL BID:** The technical proposal will be opened on **24.01.2023**, at 1 PM at Swarnachud College, Mitrapur in the presence of the tender Committee and representative of the bidders. No separate intimation will be given to the bidders in this regard.
6. **EVALUTION PROCESS:** The technical proposals will be evaluated on the basis of compliance to eligibility criteria, technical specification, and other terms and conditions stipulated in the tender documents. Financial proposal will be opened only of those bidders who qualify in the technical evaluation. The committee reserves the right to reject any or all the tenders without assigning any reason thereof.
7. **Award of contract:** Financial bid with lowest price quotation for the assignment as per **Annexure-III** will be considered for negotiation and award of contract. **However where there is tie between bidders in lowest evaluated package price, the person having highest financial turnover in the preceding 3 financial year will be given preference.**

Principle
Swarnachud College
Mitrapur
5-1-2023



8. **PERFORMANCE BANK GUARANTEE:** The selected bidder shall deposit performance security of 5% of bid value in the form of a demand draft/ fixed deposit receipt from a commercial bank within seven (07) working days of the date of notice of award of the tender. The performance security deposit will be retained till completion of the warranty period.
9. The bid not submitted in prescribed format or in prescribed manner, shall be rejected by Tender committee at the risk and responsibility of the bidder.
10. All the information as called for in the tender document should be submitted truly, clearly, legibly, transparently, unambiguously and without using any abbreviation.
11. In the financial bid the total figures should be written in figures followed by words.
12. Each page of the tender document should be signed by the bidder with seal, in token of having understood and accepted the terms and conditions of the contract and serially numbered and page marked.
13. A bid submitted cannot be withdrawn. The bidder or his authorized representative (one person only) will be allowed to be present at the time of opening of tenders.
14. The tendering authority reserves the right to accept any bid, and reject all bids at any time prior to award of contract, without assigning reasons and without thereby incurring any liability to the affected bidder or bidders or any obligation to inform the affected bidder or bidders of the grounds for the action.
15. All the transit risks shall be the responsibility of the supplier.
16. All the disputes shall be subjected to the jurisdiction of civil courts situated in Balasore.
17. Any matter which has not been covered under the provisions shall be governed as per the provision of Odisha State Government Rules.
18. If the work is found un-satisfactory or, if the firm dishonours the contract, the performance security deposit may be forfeited and the job may be entrusted to another firm. In this regard the decision of the committee is final and binding on the contractor.
19. Any notice given by one party to the other pursuant to this contract shall be sent in writing to Principal, Swarnachud College, Mitrapur, Balasore, 756020.
20. Payment terms: all payments will be made within 15 days of submission of invoice, based on completion of respective terms and conditions. The invoice will be raised in favour of Principal, Swarnachud College, Mitrapur, Balasore.
21. Completion period: The work shall be completed in all respect within 15 days from the date of issue of work order.
22. A firm can apply for any part or whole of the tender. The EMD and performance Bank Guarantee (PBG) for parts are to be provided separately.

Samachud
5-1-2023
Principal,
Swarnachud College
Mitrapur



ANNEXURE- II

DETAILS OF THE TENDERER

Sl. No	Particular	
1	Name of the Firm/Agency/Company	
2	Registered office Address & Complete postal address	
3	Telephone Number & E-Mail ID	
4	Name of the Authorized Signatory (in block letters)	
5	Contact No. of authorized signatory	
6	Type of Firm (Proprietary/ Partnership/ Pvt. Ltd./ Public Ltd.)	Tenderer has to provide relevant documents (with the technical bid) as a proof of firm type.
7	Date of Establishment and Experience in Business (In number of years)	Work order to be attached for complying point no 8 of eligibility criteria
8	GST Registration No.	
9	PAN No.	
10	Details of Earnest Money Deposit i.e. Draft no, Date and Bank Name	
11	Yearly turnover of the organization during last 3 years (year wise) and furnish audited balance sheet and Profit and loss Account for the last 3 years. 2019-20 2020-21 2021-22	
12	Furnish the names of 3 responsible persons along with their designation, address, telephone number etc. for whose organization, you have completed/work in progress who will be in a position to certify the performance of your organization.	

Date:

Place:

Signature & Seal of the Bidder

Gumalew
5-1-2023
Principal,
Swarnachud College
Mitrapur



ANNEXURE- III
PRICE SCHEDULE

To

The Principal,

Swarnachud College, Mitrapur, Balasore, 756020

Ref: Bid no.....Dated.....

Sir,

I/We _____ hereby offer to supply the following items of part
_____ at the prices and within the period indicated below.

Sl. No	Item	Company	Specification	Company Price including GST (%)	Bidder price including GST (%)	GST(%)	Warranty Period	Nature of service & Demonstration
1								
2								
3								
4								

It is herewith certified that I/We have understood the general Terms and Conditions of the bid and our offer is to supply items strictly in accordance with the requirements and the terms mentioned in the bid.

Note: No change in the Performa is permissible

Date:

Place:

Signature & Seal of the Bidder

Gemalieu
5.1.2023
Principal,
Swarnachud College
Mitrapur

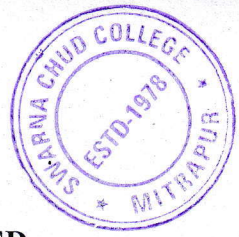

ANNEXURE- IV

SELF DECLARATION FOR NOT BLACK LISTED

To

The Principal,

Swarnachud College, Mitrapur, Balasore, 756020

Ref: Tender no.....Dated:.....

Madam/Sir,

I/Wehere by confirm that our firm has not been banned or blacklisted by any Government organization/Financial Institution/Court/Public Sector Unit/Central Government.

Date:

Place:

Signature & Seal of the Bidder

Sanjeev
5-1-2023
Principal,
Swarnachud College
Mitrapur

Items to be Supplied and Installed in DEPARTMENT OF BOTANY

1. Island Table (EPOXY PU/Poly Carbonate/Polyester/ Composite Powder Coated)

Technical Specification of Laboratory Island Table:

Dimension: 2440 mm L x 1500 mm W x 900 mm H

(i) Granite Top: The Table top must have

- a. 20mm (±1mm) finely polished thick black colour Granite with round edges, Bull nose/Chamfer moulding & Groove at the bottom.
- b. The Granite top must be designed to withstand a load of 200-300 kg per square metre.

(ii) Table Construction (under bench modules) as per specified drawing

- a. Modules must have 20 SWG pre-coated electro-galvanised sheet (TATA/Jindal/SAIL or any steel of good quality) to withstand a load of 200-300 kg per sqm with 70-80 micron thickness EPOXY PU/Poly Carbonate/Polyester Powder Coating of good international quality.
- b. Must have top lockable drawers (8 nos-150 mm H), bottom cup boards (4 nos) with horizontal removable inner partition & four lockable doors (two shutters each) with self close hydraulic hinges.
- c. Must have powder coated Stainless Steel handles for drawers & cupboards.
- d. Provision for floor levellers.
- e. The base of modules must have skirting panels.
- f. The table must be designed for aesthetic look.

(iii) To provide rate quotation for a good looking wall hanging poly propylene peg board with 25 peg

(iv) Hardware Fittings

- a. Drawer Runner – Godrej / EBCO Make/ or any other make of good quality
- b. Hinges - Godrej / EBCO Make/ or any other make of good quality
- c. Handle- Godrej / EBCO Make / or any other make of good quality
(Must be modular, body colour and powder coated finish).
- d. Lock – Godrej / EBCO make / or any other make of good quality with a pair of keys.

(v) Colour of the module - Ivory & Dark Blue

N.B: (i) No Electrical & Water connection in Botany Central Island Tables

2. Wall Tables (As per Drawings)

Dimension: 7200mm L x 600mm W x 900mm H

(i) Granite Top:-

- 20mm (+1mm) finely polished thick black colour Granite with round edges, Bull nose/Chamfer moulding & Groove at the bottom.
- The Granite top must be designed to with stand a load of 200-300 kg per square metre.

(ii) Under Bench Modules

- Top Drawer (6 Nos – 150mm H)
- Bottom Cup Board (6 Nos) with Horizontal Removable inner partition.
- Lockable Six Doors (Two Shutters each) with self close hydraulic hinges.
- Provision for floor levellers.
- Powder coated Stainless Steel handles for drawers & Cup Boards.
- The base of modules must have skirting panels.
- Provision for one 4-way Heavy duty Brass gas connector at one end.
- The modules must be designed for aesthetic look.

(iii) Hardware Fittings

- Drawer Runner – Godrej / EBCO Make/ or any other make of good quality
- Hinges - Godrej / EBCO Make/ or any other make of good quality
- Handle- Godrej / EBCO Make / or any other make of good quality
(**Must be modular, body colour, and powder coated finish**).
- Lock – Godrej / EBCO make / or any other make of good quality with a pair of keys.

(iv) Colour of the module - Ivory & Dark Blue

N.B: (i) Electrical connection in wall table must be done as per Drawing.

Electrical race way fitted with 16 A modular switch & sockets on the top of the Table – 12 Nos each (Anchor/Roma or any other make of Good Quality)

(ii) The bidder must indicate the **name of the company** for EPOXY Powder Coating and type of powder coating, Steel, PP used in Sinks & Peg Boards (also mention the thickness), and Socket & Switch in technical specification and must mention the warranty and longevity period on powder coating and tables.

Principle
Principal
Swarnachud College
Mitrapur

Principle
Coordinator OHEPEE
Co-ordinator
IDP

Sanjay Sahu
HOD (Botany)

32' (9600mm)

22' (6600mm)

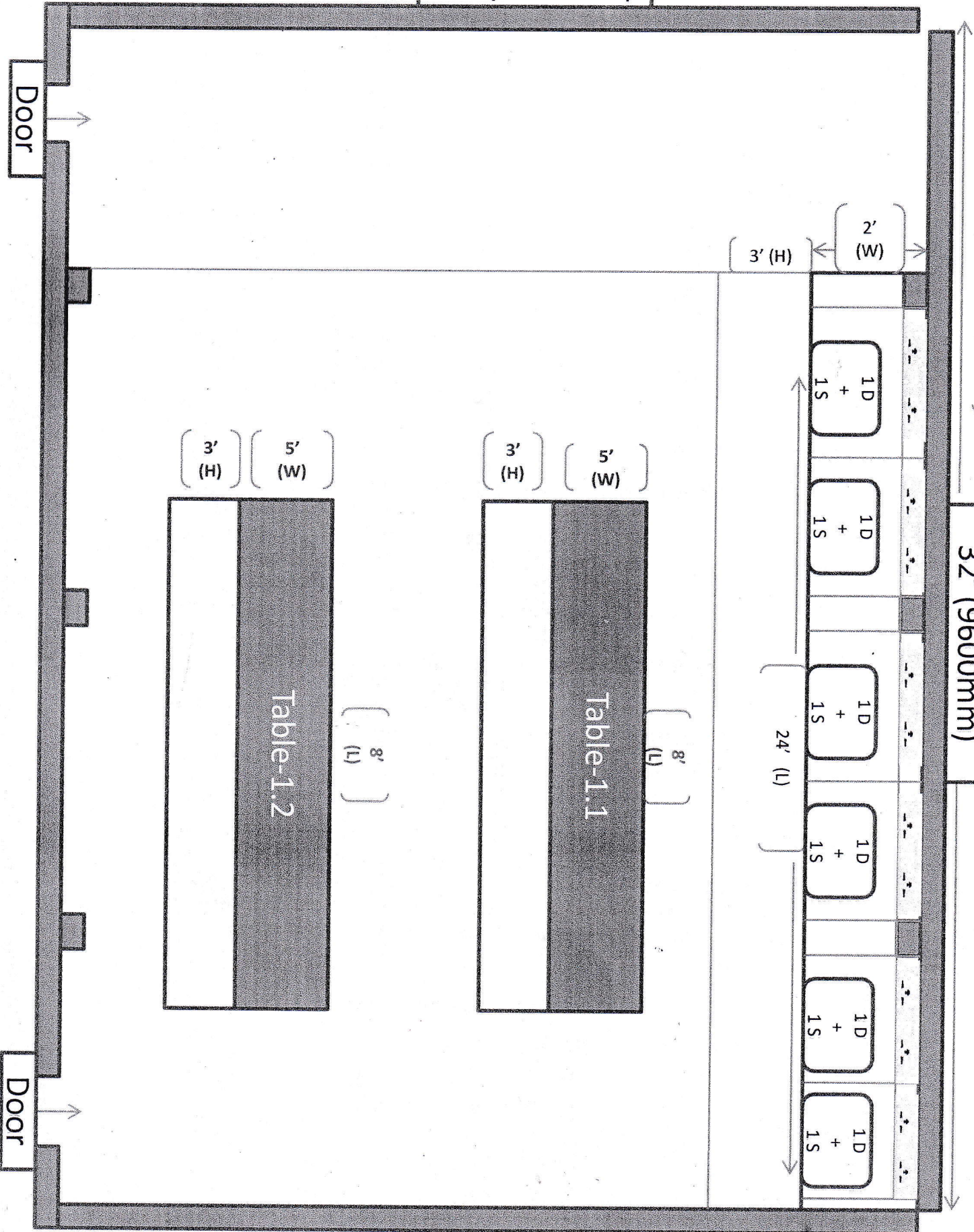

Saijunta Sahu
HOD Botany

ANNEXURE- I

Items to be Supplied and Installed in DEPARTMENT OF CHEMISTRY

1. Island Table (EPOXY PU/Poly Carbonate/Polyester/ Composite Powder Coated)

Technical Specification of Laboratory Island Table:

Dimension: 2440 mm L x 1500 mm W x 900 mm H

(i) Granite Top: The Table top must have

- a. 20mm (±1mm) finely polished thick black colour Granite with round edges, Bull nose/Chamfer moulding & Groove at the bottom.
- b. The Granite top must be designed to withstand a load of 200-300 kg per square metre.

(ii) Table Construction (under bench modules) as per specified drawing

- a. Modules must have 20 SWG pre-coated electro-galvanised sheet (TATA/Jindal/SAIL or any steel of good quality) to withstand a load of 200-300 kg per sqm with 70-80 micron thickness EPOXY PU/Poly Carbonate/Polyester Powder Coated of good international quality.
- b. Must have top lockable drawers (8 nos-150 mm H), bottom cup boards (4 nos) with horizontal removable inner partition & four lockable doors (two shutters each) with self close hydraulic hinges.
- c. Must have powder coated Stainless Steel handles for drawers & cupboards.
- d. Provision for floor levellers.
- e. The base of modules must have skirting panels.
- f. Provision for two reagent racks (900 mm L x 300mm W x 600mm H) with one good looking poly propylene peg board facility with 25 pegs.
- g. Provision for one poly propylene sink (600mm Lx 450mm W x 300mm H)
It must have
 - (1) high durability and high thickness.
 - (2) Inert towards all chemicals/Acids/Alkalis/ U.V Radiation & Oxidising agents.
- h. 3-way tap must be provided with Sink
- i. Two nos of 4 way heavy duty Brass Gas Connector for each table.
- j. The table must be designed for aesthetic look.

(iii) Hardware Fittings

- a. Drawer Runner – Godrej / EBCO Make/ or any other make of good quality
- b. Hinges - Godrej / EBCO Make/ or any other make of good quality
- c. Handle- Godrej / EBCO Make / or any other make of good quality
(Must be modular, body colour and powder coated finish).
- d. Lock – Godrej / EBCO make / or any other make of good quality with a pair of keys.

(iv) Colour of the module - Ivory & Dark Blue

N.B: (i) No Electrical connection in chemistry Central Island Tables

(ii) The bidder is required to arrange drainage system from table & gas connection system.

2. Wall Tables (As per Drawings)

Dimension: 7200mm L x 600mm W x 900mm H

(i) Granite Top:-

- 20mm (+1mm) finely polished thick black colour Granite with round edges, Bull nose/Chamfer moulding & Groove at the bottom.
- The Granite top must be designed to with stand a load of 200-300 kg per square metre.

(ii).Under Bench Modules

- Top Drawer (6 Nos – 150mm H)
- Bottom Cup Board (6 Nos) with Horizontal Removable inner partition.
- Lockable Six Doors (Two Shutters each) with self close hydraulic hinges.
- Provision for floor levellers.
- Powder coated Stainless Steel handles for drawers & Cup Boards.
- The base of modules must have skirting panels.
- The modules must be designed for aesthetic look.

(iii) Hardware Fittings

Drawer Runner – Godrej / EBCO Make/ or any other make of good quality

Hinges - Godrej / EBCO Make/ or any other make of good quality

Handle- Godrej / EBCO Make / or any other make of good quality

(Must be modular, body colour, and powder coated finish).

Lock – Godrej / EBCO make / or any other make of good quality with a pair of keys.

Colour of the module - Ivory & Dark Blue

N.B: (i) Electrical connection in wall table must be done as per Drawing.

Electrical race way fitted with 16 A modular switch & sockets on the top of the Table – 12 Nos each (Anchor/Roma or any other make of Good Quality)

(ii) The bidder must indicate the **name of the company** for EPOXY Powder Coating and type of powder coating, Steel, PP used in Sinks & Peg Boards (also mention the thickness), and Socket & Switch in technical specification and must mention the warranty and longevity period on powder coating & Tables.

Sanjeev
Principal 5-1-2023

Principal,
Swarnachud College
Mitrapur

Ramashree
Coordinator OHEPEE 5/1/23

Co-ordinator
IDP

Shree
HOD 05/01/2023

DEPT. OF CHEMISTRY

32' (9600mm)

22' (6600mm)

Handwritten signature and date: 10/11/2023

Door

Door

2' (W)
3' (H)

1D
+
1S

1D
+
1S

1D
+
1S

1D
+
1S

1D
+
1S

1D
+
1S

24' (L)

Table-1.1

5' (W)
3' (H)

8' (L)

Table-1.2

5' (W)
3' (H)

8' (L)

Table-1.3

5' (W)
3' (H)

8' (L)

Table-1.4

5' (W)
3' (H)

8' (L)

Items to be Supplied and Installed in DEPARTMENT OF PHYSICS

1. Island Table (EPOXY PU/Poly Carbonate/Polyester/ Composite Powder Coated)

Technical Specification of Laboratory Island Table:

Dimension: 2440 mm L x 1500 mm W x 900 mm H

(i) Granite Top: The Table top must have

- a. 20mm (+1mm) finely polished thick black colour Granite with round edges, Bull nose/Chamfer moulding & Groove at the bottom.
- b. The Granite top must be designed to with stand a load of 200-300 kg per square metre.

(ii) Table Construction (under bench modules) as per specified drawing

- a. Modules must have 20 SWG pre-coated electro galvanised sheet (TATA/Jindal/SAIL or any steel of good quality) to withstand a load of 200-300kg per sqm with 70-80 micron thickness EPOXY PU/Poly Carbonate/Polyester Powder Coated of good international quality.
- b. Must have top lockable drawers (8 nos – 150mm H), bottom cup boards (4 nos) with horizontal removable inner partition & four lockable doors (two shutters each) with self close hydraulic hinges.
- c. Must have powder coated Stainless Steel handles for drawers & cupboards.
- d. Provision for floor levellers.
- e. Must have electrical connection with Switch and Sockets 8 nos each in both side of the table. (Anchor/ Roma/ Any other make of good quality)
- f. The base modules must have skirting panels.
- g. The table must be designed for aesthetic look.

(iii) Hardware Fittings

Drawer Runner – Godrej / EBCO Make/ or any other make of good quality

Hinges - Godrej / EBCO Make/ or any other make of good quality

Handle- Godrej / EBCO Make / or any other make of good quality

(must be modular, body colour, and powder coated finish).

Lock – Godrej / EBSO make / or any other make of good quality with a pair of keys.

Colour of the module - Ivory & Dark Blue

2. Wall Table - 1 (As per Drawing)

Dimension: 7200mm L x 600mm W x 900mm H

(i) Granite Top:-

- a. 20mm (±1mm) finely polished thick black colour Granite with round edges, Bull nose/Chamfer moulding & Groove at the bottom.
- b. The Granite top must be designed to withstand a load of 200-300 kg per square metre.

(ii) Under Bench Modules

- a. Top Drawer (6 Nos with 150 mm H)
- b. Bottom Cup Board (6 Nos) with Horizontal Removable inner partition.
- c. Lockable Six Doors (Two Shutters each) with self close hydraulic hinges.
- d. Provision for floor levellers.
- e. Powder coated Stainless Steel handles for drawers & Cup Board.
- f. The base of modules must have skirting panels.
- g. The modules must be designed for aesthetic look.

(iii) Hardware Fittings

- a. Drawer Runner – Godrej / EBCO Make/ or any other make of good quality
- b. Hinges - Godrej / EBCO Make/ or any other make of good quality
- c. Handle- Godrej / EBCO Make / or any other make of good quality

(Must be modular, body colour, and powder coated finish).

- d. Lock – Godrej / EBCO make / or any other make of good quality with a pair of keys.

(iv) Colour of the module - Ivory & Dark Blue

N.B: (i) Electrical connection in wall table must be done as per Drawing.

Electrical race way fitted with 16 A modular switch & sockets on the top of the Table – 12 Nos each (Anchor/Roma or any other make of Good Quality)

(ii) The bidder must indicate the **name of the company** for EPOXY Powder Coating and type of powder coating, Steel, PP used in Sinks & Peg Boards, Socket & Switch in technical specification and must mentioned warranty and longevity period on powder coating & tables.

Wall Table- 2 (As per Drawing)

Dimension: 4800mm L x 600mm W x 900mm H

(i) Granite Top:-

- 20mm (± 1 mm) finely polished thick black colour Granite with round edges, Bull nose/Chamfer moulding & Groove at the bottom.
- The Granite top must be designed to with stand a load of 200-300 kg per square metre.

(ii) Under Bench Modules

- Top Drawer (150 mm H - 4 nos)
- Bottom Cup Board (4 Nos) with Horizontal Removable inner partition.
- Lockable Four Doors (Two Shutters each) with self close hydraulic hinges.
- Provision for floor levellers.
- Powder coated Stainless Steel handles for drawers & Cup Board.
- The base of modules must have skirting panels.
- The modules must be designed for aesthetic look.

(iii) Hardware Fittings

- Drawer Runner – Godrej / EBCO Make/ or any other make of good quality
- Hinges - Godrej / EBCO Make/ or any other make of good quality
- Handle- Godrej / EBCO Make / or any other make of good quality
(**Must be modular, body colour, and powder coated finish**).
- Lock – Godrej / EBSO make / or any other make of good quality with a pair of keys.

(iv) Colour of the module - Ivory & Dark Blue

N.B: (i) Electrical connection in wall table must be done as per Drawing.

Electrical race way fitted with 16 A modular switch & sockets on the top of the Table – 8 Nos each (Anchor/Roma or any other make of Good Quality)

(ii) The bidder must indicate the **name of the company** for EPOXY Powder Coating, Steel, PP used in Sinks & Peg Boards, Socket & Switch in technical specification and must mention the warranty and longevity period on powder coating and tables.

Sanjeev
Principal 5-1-2023
Swarnachud College
Mitrapur

Sanjay
Coordinator OHEPEE 5/1/23
Co-ordinator
IDP

Sanjay
HOD 5-1-23

DEPT. OF PHYSICS

32' (9600mm)

22' (6600mm)

for 6/1/23

3' (H)

2' (W)

1D
+
1S

1D
+
1S

1D
+
1S

1D
+
1S

1D
+
1S

1D
+
1S

24' (L)

8' (L)

Table-1.1

5' (W)

3' (H)

8' (L)

Table-1.2

5' (W)

3' (H)

16' (L)

1D
+
1S

1D
+
1S

1D
+
1S

1D
+
1S

3' (H)

2' (W)

Door

Door

Items to be Supplied and Installed in DEPARTMENT OF ZOOLOGY

1. Island Table (EPOXY PU/Poly Carbonate/Polyester/ Composite Powder Coated)

Technical Specification of Laboratory Island Table:

Dimension: 2440 mm L x 1500 mm W x 900 mm H

(i) Granite Top: The Table top must have

- a. 20mm (± 1 mm) finely polished thick black colour Granite with round edges, Bull nose/Chamfer moulding & Groove at the bottom.
- b. The Granite top must be designed to withstand a load of 200-300 kg per square metre.

(ii) Table Construction (under bench modules) as per specified drawing

- a. Modules must have 20 SWG pre-coated electro-galvanised sheet (TATA/Jindal/SAIL or any steel of good quality) to withstand a load of 200-300 kg per sqm with 70-80 micron thickness EPOXY PU/Poly Carbonate/Polyester Powder Coated of good international quality.
- b. Must have top lockable drawers (8 nos- 150 mm H), bottom cup boards (4 nos) with horizontal removable inner partition & four lockable doors (two shutters each) with self close hydraulic hinges.
- c. Must have powder coated Stainless Steel handles for drawers & cupboards.
- d. Provision for floor levellers.
- e. The base of modules must have skirting panels.
- f. The table must be designed for aesthetic look.

(iii) To provide rate quotation for a good looking wall hanging poly propylene peg board with 25 peg

(iv) Hardware Fittings

- a. Drawer Runner – Godrej / EBCO Make/ or any other make of good quality
- b. Hinges - Godrej / EBCO Make/ or any other make of good quality
- c. Handle- Godrej / EBCO Make / or any other make of good quality
- d. (Must be modular, body colour and powder coated finish).
- e. Lock – Godrej / EBCO make / or any other make of good quality with a pair of keys.

(v) Colour of the module - Ivory & Dark Blue

N.B: (i) No Electrical & water connection in Zoology Central Island Tables

2. Wall Tables (As per Drawings)

Dimension: 7200mm L x 600mm W x 900mm H

(i) Granite Top:-

- 20mm (±1mm) finely polished thick black colour Granite with round edges, Bull nose/Chamfer moulding & Groove at the bottom.
- The Granite top must be designed to with stand a load of 200-300 kg per square metre.

(ii) Under Bench Modules

- Top Drawer (6 Nos – 150mm H)
- Bottom Cup Board (6 Nos) with Horizontal Removable inner partition.
- Lockable Six Doors (Two Shutters each) with self close hydraulic hinges.
- Provision for floor levellers.
- Powder coated Stainless Steel handles for drawers & Cup Boards.
- The base of modules must have skirting panels.
- Provision for one 4-way Heavy duty Brass gas connector at one end..
- The modules must be designed for aesthetic look.

(iii) Hardware Fittings

- Drawer Runner – Godrej / EBCO Make/ or any other make of good quality
- Hinges - Godrej / EBCO Make/ or any other make of good quality
- Handle- Godrej / EBCO Make / or any other make of good quality
- (Must be modular, body colour, and powder coated finish).**
- Lock – Godrej / EBCO make / or any other make of good quality with a pair of keys.

(iv) Colour of the module - Ivory & Dark Blue

N.B: (i) Electrical connection in wall table must be done as per Drawing.

Electrical race way fitted with 16 A modular switch & sockets on the top of the Table – 12 Nos each (Anchor/Roma or any other make of Good Quality)

(ii) The bidder must indicate the **name of the company** for EPOXY Powder Coating and type of powder coating, Steel, PP used in Sinks & Peg Boards (also mention the thickness), and Socket & Switch in technical specification and must mention the warranty period on powder coating and tables.

Principle 5-1-2023
Principal,
Swarnachud College
Mitrapur

Sanam Mahapatra 5/1/23
Coordinator OHEPEE
Co-ordinator
IDP

Tanushree Mahapatra
HOD 01/01/2023

32' (9600mm)

22' (6600mm)

2' (W)
3' (H)

1D
+
1S

1D
+
1S

1D
+
1S

1D
+
1S

1D
+
1S

1D
+
1S

24' (L)

8' (L)

5' (W)
3' (H)

Table-1.1

5' (W)
3' (H)

Table-1.2

8' (L)

Door

Door

Items to be Supplied and Installed in Class Rooms & Labs

1. White Board/ Green Board

Specification:

- a. Dimension: 2400 mm x 1200 mm
- b. Separate rate for magnetic, Non-Magnetic, Ceramic and Non-Ceramic Type as per Annexure -3 (Price Schedule).

2. Chemicals Storage Cabinet (EPOXY based of good quality)

- a. Dimension: 1981 mm H x 914 mm W x 1483mm D with four shelves.
- b. Must have 20 SWG pre-coated electro-galvanised sheet (TATA/Jindal/SAIL or any steel of good quality) to withstand a load of 200-300 kg per sqm with 70-80 micron thickness EPOXY PU/Poly Carbonate/Polyester/ Composite Powder Coated of good international quality.
- c. Must have powder coated Stainless Steel handles.
- d. Provision for floor levellers.
- e. the body of the storage cabinet must be inert towards all chemicals/acids/alkalis/ any oxidizing agents
- f. The table must be designed for aesthetic look.

(iii) Hardware Fittings

- a. Handle- Godrej / EBCO Make / or any other make of good quality
(**Must be body colour and powder coated finish**).
- b. Lock – Godrej / EBCO make / or any other make of good quality with a pair of keys.

(iv) Colour - Ivory & Dark Blue

N.B: (i) The bidder must indicate the **name of the company** for EPOXY Powder Coating and type of powder coating, Steel, used in technical specification and must mention the warranty and longevity period on powder coating & Storage Cabinet.

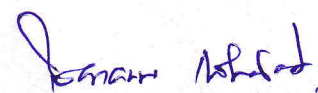
Coordinator OHEPEE 5/1/23

Co-ordinator
IDP

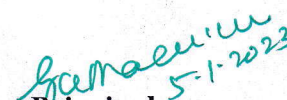
Principal 5-1-2023
Principal,
Swarnachud College,
Mitrapur